

Hello families!

This year we will be using Seesaw! Seesaw is a fun and engaging virtual learning tool for your young learner and you, their caregivers!

Seesaw has two apps - Seesaw CLASS and Seesaw FAMILY. Seesaw CLASS is for the students to complete activities the teacher assigns and add to their journal on their own! You'll log on to CLASS with a text code your teacher provides you that is for your specific child. Seesaw FAMILY is meant for you, the adults, to see your students work and communicate with their teacher. We will still be using the FAMILY account to communicate with the adults. You'll continue to log on to FAMILY using your personal email and password.

Do this first:

What is Clever?

Clever is a "portal" where you can access many apps used by your student's school or classroom teacher(s). Visit www.bostonpublicschools.org/backpack to access Clever.

How can my student login?

[*Watch an interactive step-by-step tutorial.*](#)

There are two ways to access Clever:

- use your BPS Gmail and password
- sign in with a Clever Badge

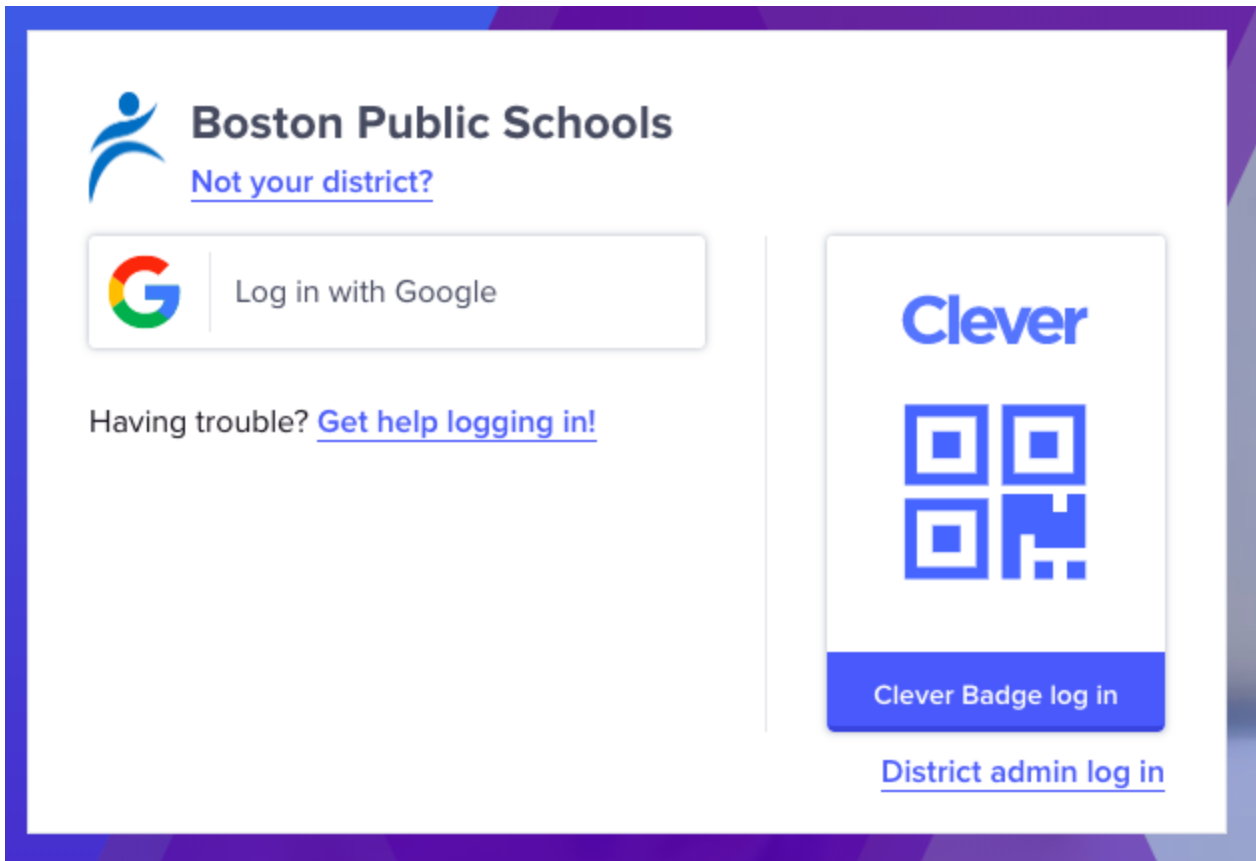

Option 1: Use your BPS Gmail and password.

1. Go to www.clever.com/in/bostonpublic.
2. Press the "Log in with Google" button. You should login with your BPS Gmail and password.

Option 2: Sign in with a Clever Badge.

On a BPS-managed Chromebook

Turn on the Chromebook and click "Next" at the login screen to be presented with the camera window. If students want to login with their Gmail account, they should click "Sign in with a different account" instead.

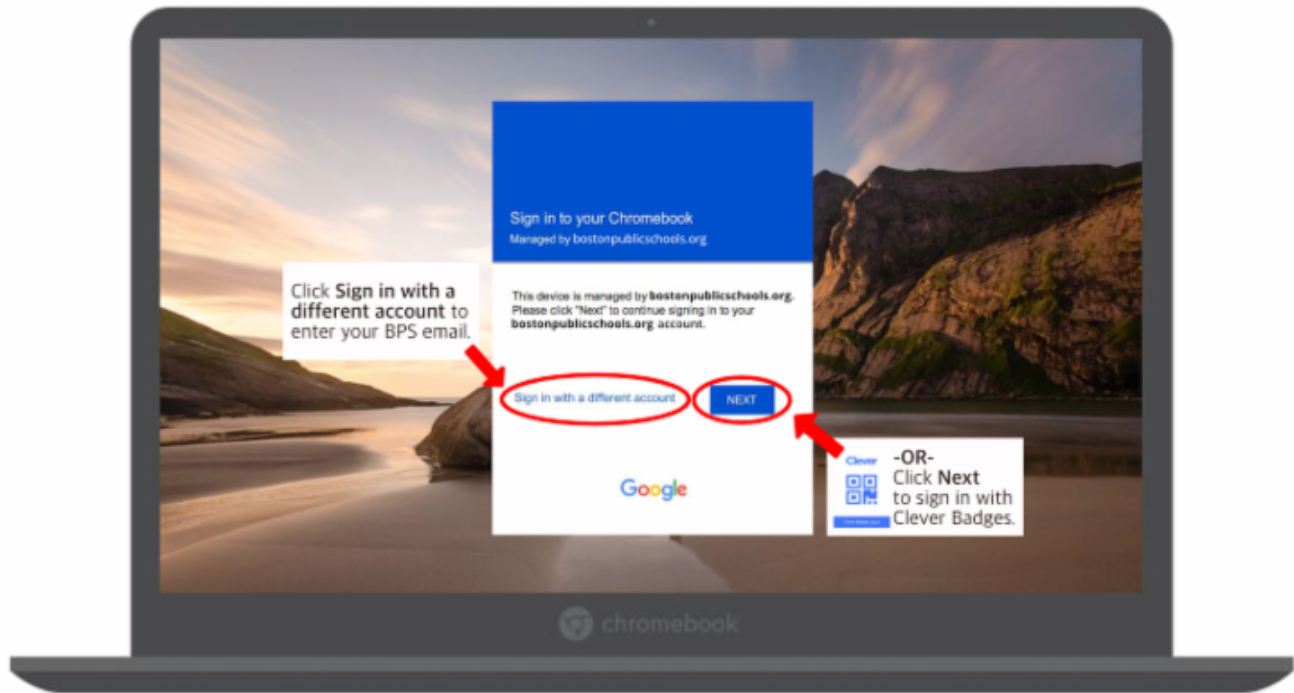

On Mac and Windows Devices

Go to the Clever login screen by visiting www.clever.com/in/bostonpublic. Click the QR code icon to the right of the "Login with Google" button to be presented with the camera window.

Clever



Clever Badge Log in

You will receive a badge from your teacher.

Here are the download/usage directions:

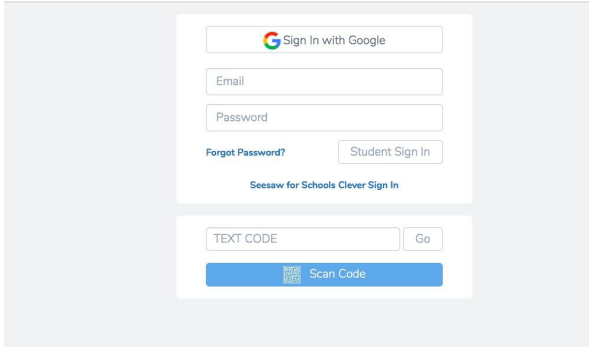
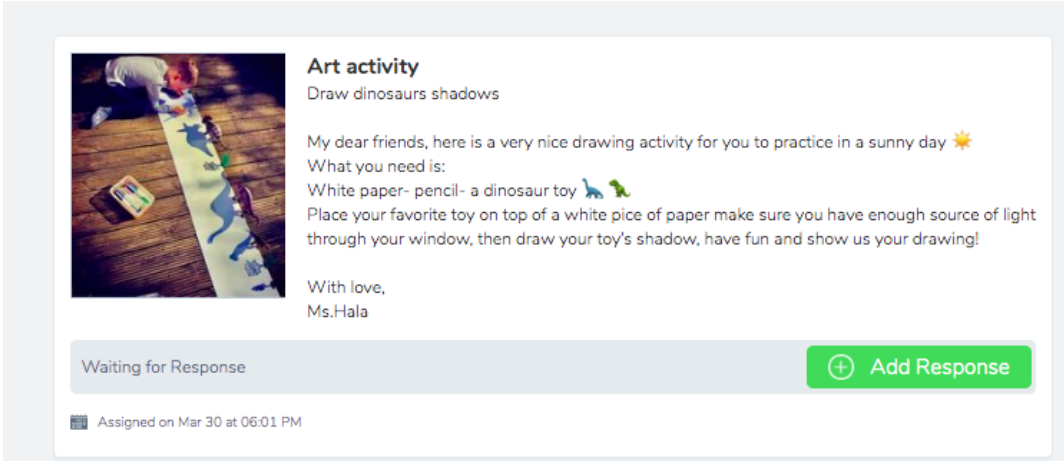
	Chromebook/Laptop	Phone/Tablet
1.	Link coming soon Use this link to add	Download the Seesaw CLASS app and the parent app
2.	Download the parent app	
3.	<p>Log in with Clever first and choose Seesaw on the teacher page, and then log in with your child's google email and password. .</p> <div style="display: flex; justify-content: space-around;">   </div>	
4.	Find the “ Activities ” Tab	
5.	<div style="border: 1px solid #ccc; padding: 10px; background-color: #f9f9f9;">  <p>Read the directions for the Activities and then choose “Add response” when the child has done the work.</p> </div>	

6.

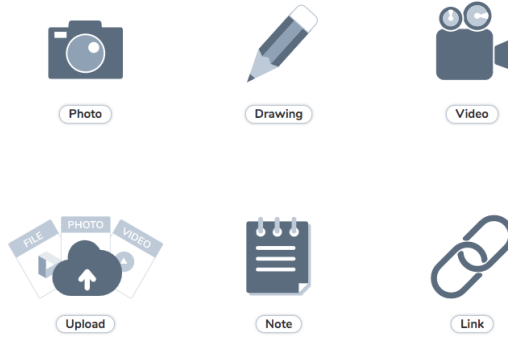

For our grade, most of the work won't be done on the actual computer so you're most likely taking a **photo** or **video** or **uploading** from your camera roll!

Some of the activities might let them use the “**DRAWING**” feature.

They definitely will not be using NOTE or LINK so you can ignore those :)